

Features

- Can select measurement accuracy : $\pm 1\%$, $\pm 2\%$, $\pm 3\%$
- Can select the 4~20mA * 2wire type and the battery type.
- Measurement of low flow rates and minimum flow velocity of 0.01m/s
- No pressure loss and a zero fault rate with no running parts
- High-efficient battery used up to 6 to 10 years
- IP68-rated protection, and used 2 meter deep water.
- High-temperature erosion-resistant ceramic sensors, and operating temperature ranging from -40 to 160 °C
- Can select the vertical or horizontal view and the remote type.
- Displays circulation such as forward(and reverse)-direction totalize flow rate, instant flow rate and flow velocity.



Description

ientek 7500 Series is an ultrasonic flow meter designed to address shortcomings of the existing fluid flow meters.

It adopts the same standard as the existing pipes, so it can be applied and installed for a wide range of DN15~DN1000mm pipes.

The battery type is designed to measure flow rates for 6 to 10 years without power connection, and users can also select the 4~20mA * 2wire type, which requires electric current output.

Combines merits of the existing volumetric type, variable area, turbine, parasitic and electronic flow meters, and provides the output of RS-232, RS-485 and 4~20mA electric currents as basics, with M-BUS, GPRS and CDMA communications available as options.

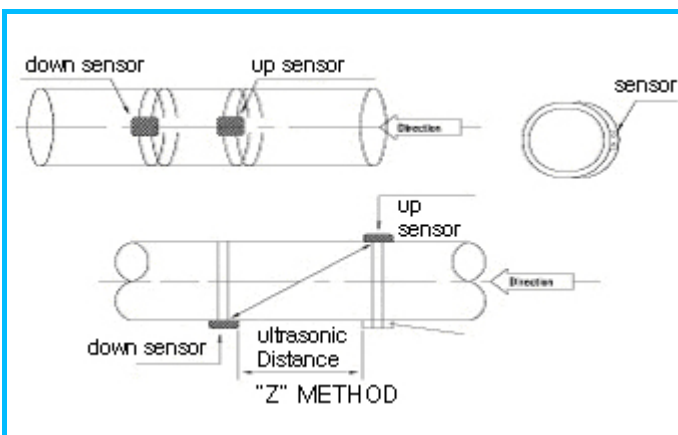

7500 Series Ultrasonic Hydro meter

Performance Specifications

Accuracy

±1%, ±2%, ±3% of Full scale

Repeatability

<±0.5%

Measurement Cycle

Factory shipping hour 3 Seconds (1~31 Seconds Selection)

Operating Specifications

Measurement Principle

Ultrasonic time differential method measures flow velocity depending on properties of changes occurring in ultrasonic radio wave speeds.

Operation

Operations with the internal key and magnetic bar

Fluid Measured

Water and other water

Application Temperature

Ambient .. - 40°F to 176°F (-40°C to +80°C)
(LCD display : -13°F to 140°F (-25°C to +60°C))
Fluid - 40°F to 320°F (-40°C to +160°C)

Display

Displays a wide range of status on a super low power-consuming LCD as below.
Forward (or reverse)-direction totalize flow rate, instant flow rate, flow velocity, totalize flow rate time, date, operating status error codes, remaining battery power, strength of ultrasonic signals, signal quality and fluid sound velocity.

Output signal

RS-232, RS-485, 4~20mA (Basic fact)
M-BUS, GPRS, CDMA (Option)

Communication protocol

Standard M-BUS Communication protocol GPRS, CDMA Communication protocol
It follows in the order Specifications and Communication protocol production it is possible.

Sensor

High-temperature erosion-resistant ceramic sensor
Application Temperature : -40°F to 320°F (-40~160°C)

Pipe

All-in-one die casting pipes (with water pipe standard) and selection from DN15 to DN1000 standard range.

Other

- Displays results of measurement in circulation.
Programmable
- Self-diagnose and display of fault
- Can select the unit of totalize flow rate.
(1, 0.1, 0.01, 0.001, 0.0001m³)
- Communication baud rate : 300, 1200, 2400, 4800
- Can select the Vertical view, Horizontal view, Remote
- Displays monthly totalize flow rate and flow velocity for 24 months.
- 8-bit forward and reverse-direction totalize flow meter and 64-bit inner calculation

Power Requirements

A single 3.6V lithium battery can be used for up to 6 to 10 years.
2Wire 4~20mA allows normal operations without a battery
Normal operations without a battery for RS-232 output
Separate 5V power supply without a battery is required for normal operations of RS-485 output.

Power Consumption

- When the measurement cycle is 3 seconds and the pipe is 100mm, average power consumption is 0.55mW.
- When the measurement cycle is 1 seconds and the pipe is 100mm, average power consumption is 1.65mW.
- When the pipe is empty, the mode is automatically switched to power-saving, reducing power consumption to less than 30% compared to normal operations for longer battery lifespan.

Physical Specifications

Wetted Materials

Cast aluminum

Enclosure

IP68

Explosion-proof for Class

Nature safety Explosion

Dimensional Specification

1. Horizontal view

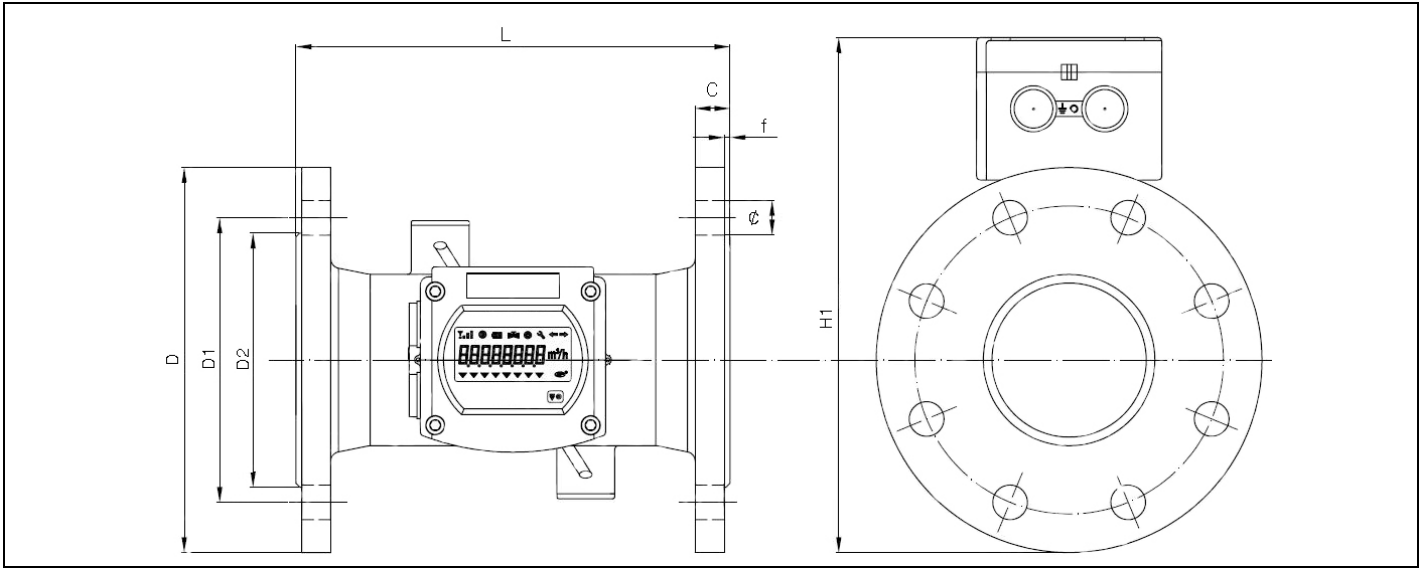

2. Vertical view

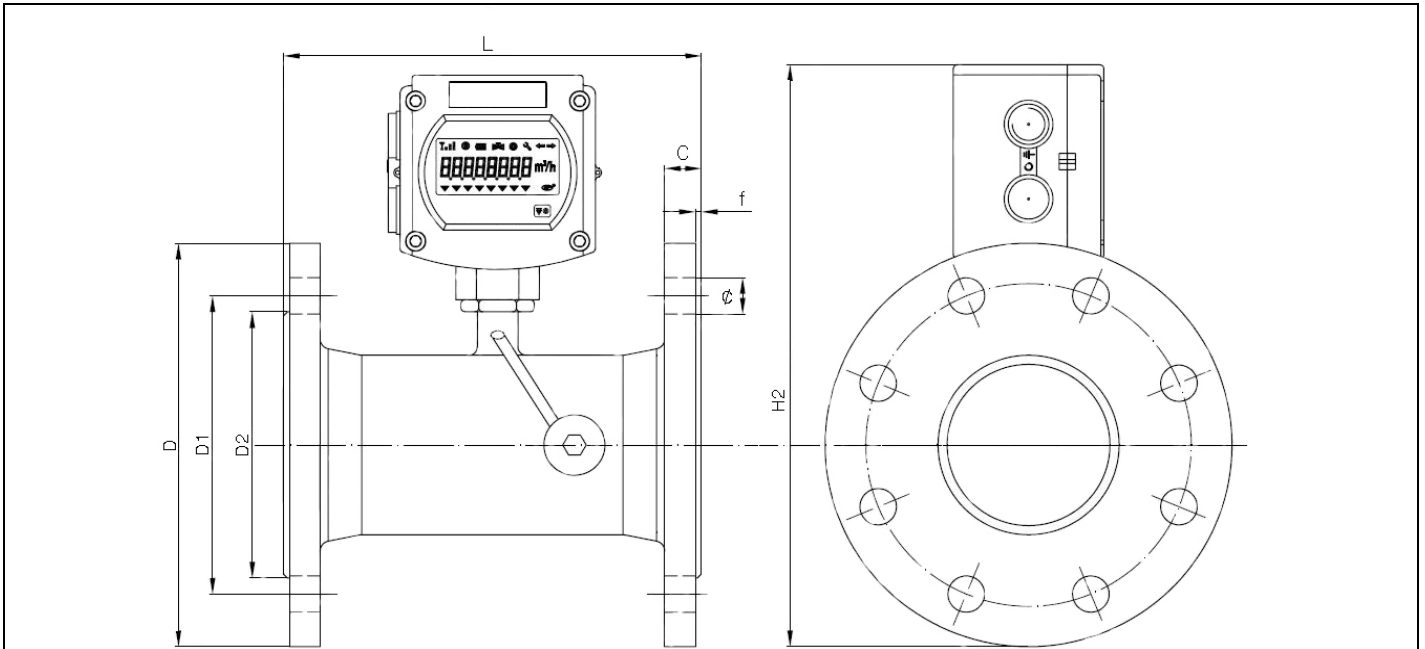

3. Remote Type

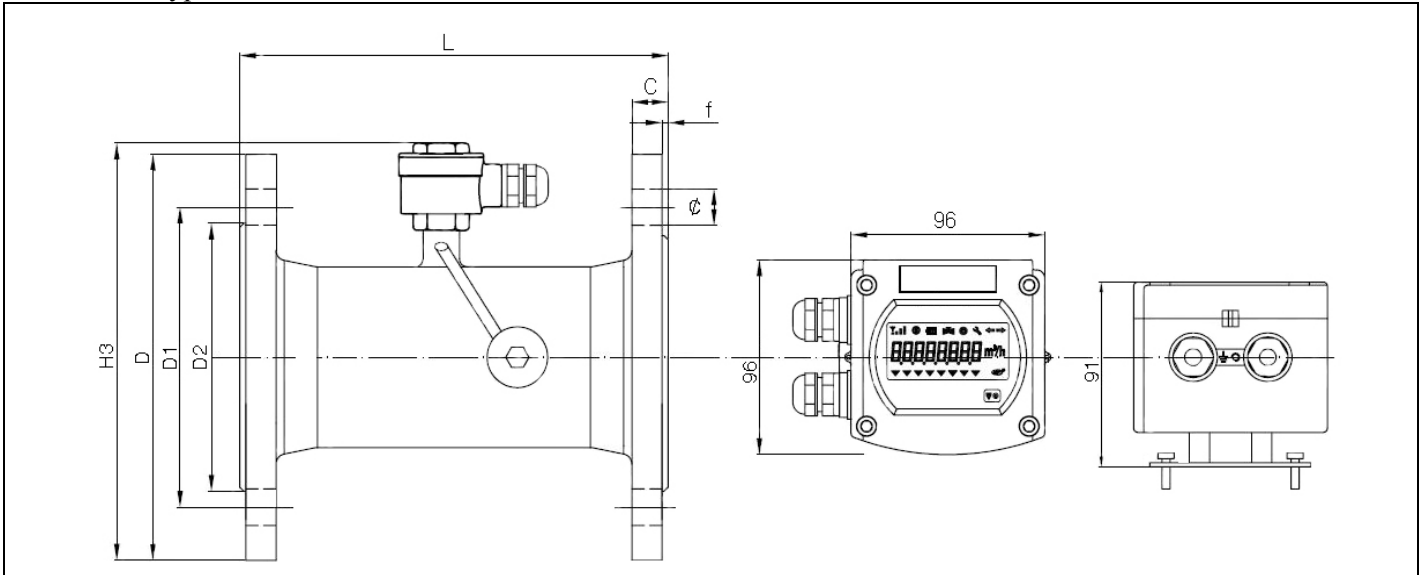

PIPE Standard

Unit : mm

PIPE DIA(DN)	Length(L)	Width(W)	Height(H)	Connector	Weight(kg)	Pressure(MPa)
15	165	96	132	G3/4B	1.25	4.0
20	195	96	138	G1B	1.7	
25	225	96	147	G1 1/4B	2.4	
32	230	96	153	G1 1/2B	2.7	
40	245	96	165	G2B	4.8	

Unit : mm

PIPE DIA (DN)	Length (L)	Flange Outer(D)	D1	Φ x n	Inner diameter		C	Height			Weight (kg)	Pressure (MPa)
					D2	f		H1	H2	H3		
50	200	165	125	18x4	99	3	20	234	255	172	7.5	1.6
65	200	185	145	18x4	118	3	20	254	275	192	10.2	
80	225	200	160	18x4	132	3	20	268	289	206	11.0	
100	250	220	180	18x8	156	3	22	287	308	225	13.5	
125	250	250	210	18x8	184	3	22	315	336	253	17.5	
150	300	285	240	18x8	211	3	24	345	366	285	22.8	
200	350	340	295	22x8	266	3	24	403	424	341	34.2	
250	450	405	355	22x12	319	3	26	462	483	405	65.8	
300	500	460	410	26x12	370	4	28	516	537	460	76.6	
350	550	520	470	26x12	429	4	30	572	593	520	86.4	
400	600	580	525	26x16	480	4	32	626	647	580	121	
450	700	640	585	30x20	548	4	34	682	703	640	168	
500	800	715	650	33x20	609	4	36	745	766	715	256	
600	1000	840	770	36x20	720	5	38	858	879	840	295	
700	1100	910	840	36x24	794	5	40	938	959	910	323	
800	1200	1025	950	39x24	901	5	42	1046	1067	1025	386	
900	1300	1125	1050	39x28	1001	5	44	1146	1167	1125	465	
1000	1400	1255	1170	42x28	1112	5	46	1261	1282	1255	510	

Factor 2 (P)153-803
 Daeryung Technotown 5th #407
 493, Gasan-dong Gumcheon-Gu Seoul, Korea
 TEL : +82(2)-2107-7999 FAX : +82(2)-2107-7990
 www.flowcountry.com , www.flowcountry.co.kr

Type **Agency** **Flange Spec.** **Materials** **Accuracy** **Power** **Output** **Comm.** **Display** **Comm. S** **Unit** **Measure C.** **Option**
UHM75 **1 0 S** - [] - [] [] [] - [] - [] - [] - [] - [] - [] - [] - [] - [] - []
 1 2 3 4 5 6 7 8 9 10 11 12 13

Model Direction	Code 1
Ultrasonic Hydro Meter	10
Agency approved, customer specified	W

Flange Standard	Code 2
DIN Flange	D
ANSI Flange	A
Agency approved, customer specified	W

Flange Spec. ³	Code 3
Size	
0.5-inch (DN15)	015
0.8-inch (DN20)	020
1-inch (DN25)	025
1.25-inch (DN32)	032
1.5-inch (DN40)	040
2-inch (DN50)	050
2.5-inch (DN65)	065
3-inch (DN80)	080
4-inch (DN100)	100
5-inch (DN125)	125
6-inch (DN150)	150
8-inch (DN200)	200
10-inch (DN250)	250
Other	()mm

Pipe Materials	Code 4
Carbon steel	0
Stainless steel	1
Cast iron	2
Copper pipe	3
Copper iron pipe	4
Agency approved, customer specified	W

Accuracy (F.S.)	Code 5
1%	A
2%	B
3%	C
Agency approved, customer specified	W

Input Power	Code 6
3.6V Lithium battery	B
Electro current loop (4~20mA 2wire)	L
RS-232	R
Agency approved, customer specified	W

Output	Code 7
Attached 4~20mA electric current loop	0
RS-232, RS-485	4
Attached GPRS	G
Attached M-BUS	M
Agency approved, customer specified	W

Communication	Code 8
None	N
Odd	Q
Even	E
Agency approved, customer specified	W

Display	Code 9
Vertical view	0
Horizontal view	1
Remote ()m	2
Agency approved, customer specified	W

Communication Speed	Code 10
300 Baud rate	1
1200 Baud rate	2
2400 Baud rate	3
4800 Baud rate	4
Agency approved, customer specified	W

Totalize Unit	Code 11
1 m3	0
0.1 m3	1
0.01 m3	2
0.001 m3	3
0.0001 m3	4
Agency approved, customer specified	W

Measurement Cycle	Code 12
1 ~ 31 Seconds Selection	1

Option	Code 13
Pressure Test Certificate	PT
Certificate of Conformance	CC

